

III/8 II/8

I/8 Pu=52,65 m2 bez loggi
M 2-3 Pp=39,73 m2
Pg=12,92 m2

III/1 II/1

I/1 Pu=52,65 m2 bez loggi
M 2-3 Pp=39,73 m2
Pg=12,92 m2

C

B

A

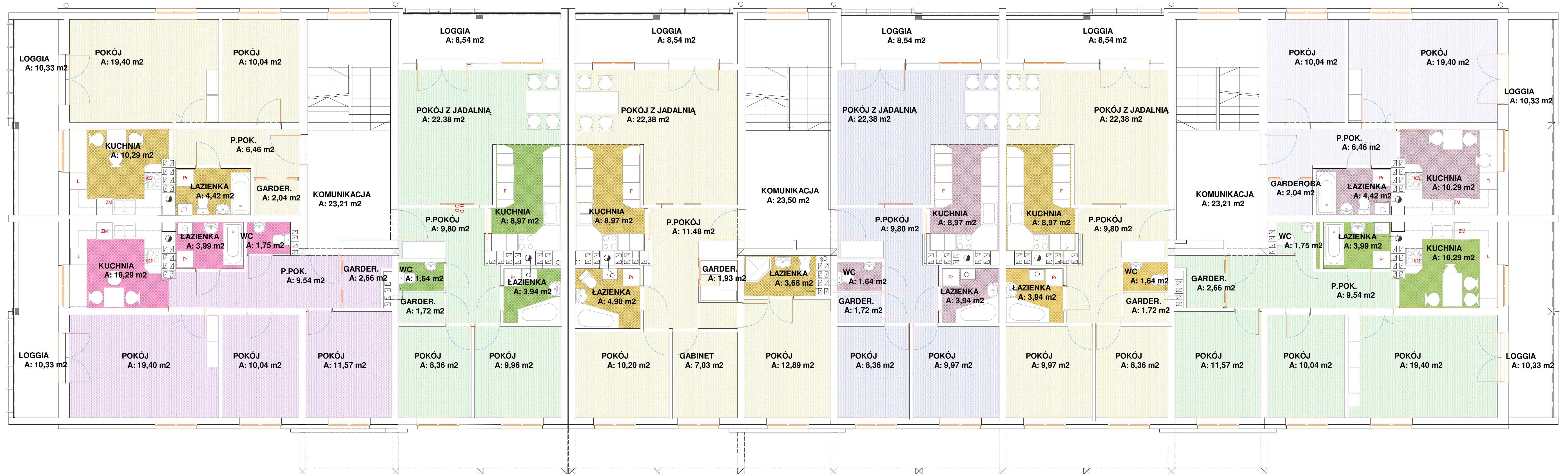

III/7 II/7

I/7 Pu=69,24 m2 bez loggi
M 4-5 Pp=51,30 m2
Pg=17,94 m2

III/6 II/6

I/6 Pu=66,78 m2 bez loggi
M 3-4 Pp=49,68 m2
Pg=17,10 m2

III/5 II/5

I/5 Pu=83,46 m2 bez loggi
M 4-5 Pp=61,47 m2
Pg=21,99 m2

III/4 II/4

I/4 Pu=66,78 m2 bez loggi
M 3-4 Pp=49,68 m2
Pg=17,10 m2

III/3 II/3

I/3 Pu=66,78 m2 bez loggi
M 3-4 Pp=49,68 m2
Pg=17,10 m2

III/2 II/2

I/2 Pu=69,24 m2 bez loggi
M 4-5 Pp=51,30 m2
Pg=17,94 m2

RZUT I PIĘTRA